

# GARDEN NEWS

Winter 2013

A garden never truly sleeps, not even in winter - and Haldane classes have braved the cold to explore the changes happening in the snowy school garden. As part of Everyday Math, students used their hands to measure beds and their legs to calculate garden length (79 paces!). They also hunted for natural polygon shapes, investigated seedpods, evergreens, precipitation, sprouting cover crops and animal tracks, and picked up trash to keep the garden clean. Students even hung up charming, hand-made birdfeeders.

The Garden Committee has kept busy this winter too, working on official **plant labels**. Read on to find out how they'll look, and why it's important to know a plant's botanical name.

Remember the Caveman (or "Dinosaur") Gourd growing in the garden last fall? Stop by Ms. Cendali's classroom to see what **Haldane's own custodian, Tenny**, created out of this gourd! Tenny hollowed out and shellacked a gourd into a perfect giant scoop or ladle. He graciously donated it to the school for students and staff to enjoy...

## One student's recent garden notes:

January 14, 2013

*Last week, I went to the Haldane garden to make some observations. The first thing I noticed was that kale stalks had no leaves. The Brussels sprouts wilted, but they were still alive. Snow had covered the raised bed and there were no plants. I had noticed that the shaded area was still covered with snow. However, the area that had sun, the snow melted. The flowering cabbage was still alive and a bright white color. The grass had grown where the pumpkin patch was. The banana plant was dead also.*

*Next year we will be ready to plant more and make new observations and reap the benefits. ----- By Edward*



Brussels sprouts in snow...  
*Brassica oleracea*

## What's in a Name?

All living things are known by common names and botanical names. Botanical names help scientists across the globe communicate despite speaking different languages - since potato (English), Kartoffel (German), brambor (Czech), and pomme de terre (French) sure don't sound like the same plant!

*Solanum tuberosum* (Latin) is the international way to talk potatoes and refers to the plant **species**.

*Solanum* is the **genus**  
*tuberosum* is the **specific epithet**

Potatoes belong to a larger **plant family** known as Solanaceae [say: so-lan-a-c-e] or the Nightshades.

**Sneak Peek at a few grade level projects coming this spring....**

- **Kindergarten:** Mrs. Cretara's class will plant sugar snap peas.
- **1<sup>st</sup> Grade:** will plant several different spring vegetables and flowers.
- **2<sup>nd</sup> Grade:** will plant sunflowers and investigate tulip bulbs post bloom.
- **3<sup>rd</sup> Grade:** will participate in a national "giant cabbage" growing program.
- **4<sup>th</sup> Grade:** will grow edible plant parts: roots, stems, leaves.
- **Project Careers:** will plant a 'rainbow garden' of colored peppers and carrots.

**LOOKING AHEAD TO SPRING**



Here's a **sample of the kinds of plant labels** you can expect to see sprouting in the garden soon. Haldane's Red Banana was donated by Charles Day, Wave Hill Garden's official Horticultural Interpreter and plant label guru. Mr. Day manages the plant labels at Wave Hill, ensuring the information is scientifically correct. We are fortunate to have his colleague Laurel Rimmer helping us make sure Haldane's plant labels are also as accurate as possible. Thanks, Laurel!

**Red Banana**  
***Ensete ventricosum 'Maurelii'***

Musaceae (Banana Family)  
Native to: Africa

The **Haldane Greenhouse** will soon be ready for use, thanks to the **Philipstown Garden Club** (PGC). And once the weather warms up, about **400 daffodils** planted throughout the Haldane campus will burst into bloom thanks to PGC member Elise LaRocco (and her team of planters: Beverly Leardi, Andrea Maasik, Linda Speziale, Jennifer Sandlund). The Garden Conservancy donated 1,000 bulbs total to PGC, some of which went to Garrison School and some to Haldane.

Ms. Cendali's art students have begun work on the official **new garden entrance sign**, which we hope to see unveiled this spring! Haldane's maintenance crew will also assist with construction.

**BREAKING NEWS: HSF helps us 'Raise a Green Roof'!**

Thanks to the continued generosity of HSF, the garden committee hopes to begin work on a **new storage shed** this spring. The shed will be able to safely house more tools and supplies, allow for a potting table, and hold classroom cubbies for storing resources and grade-level projects. It will also showcase a living green roof! We're looking for community members interested in getting involved now to help with labor, material donations, or fundraising. On April 12 we'll also host a **'Raise the Roof' dance party** at the Living Room to raise funds and support. Stay tuned!

## WANT TO HELP?

- Please contact us if you're interested in donating building materials or labor for the new shed.
- More trellises or lattice pieces needed to screen the chain link fence for our neighbors' privacy.
- Plant donations: always looking for spring and fall flowering perennials or plants with winter interest, if you can spare any from your home gardens! Contact us with questions.

## THANKS AGAIN to...

- **Flagler Landscaping** for keeping the garden regularly mowed.
- **Carina Frantz** and **Erin Garrett-Metz** for nailing back together a broken fence section!
- **PGC** for greenhouse renovation work & **The Garden Conservancy** for their daffodil donation.
- As always, we are grateful for the continuing support and original start-up grants from the **HSF** and **HHLT** without which Haldane's garden would not exist...

### **Haldane Garden Committee**

*Beth Sigler, Melissa Angier, Melany Campanile, Carina Frantz, Lourdes Laifer, Diana Geller, Kory Riesterer, Danielle Pack McCarthy, Erin Garrett-Metz, Julia Zern, Carolyn Llewellyn, Sandy McKelvey, and our 'Botanical Consultant' Laurel Rimmer*

**Contact:** [info@growinghaldane.com](mailto:info@growinghaldane.com)

**Visit:** [www.growinghaldane.com](http://www.growinghaldane.com)

## Plan for New Garden Shed with Green Roof

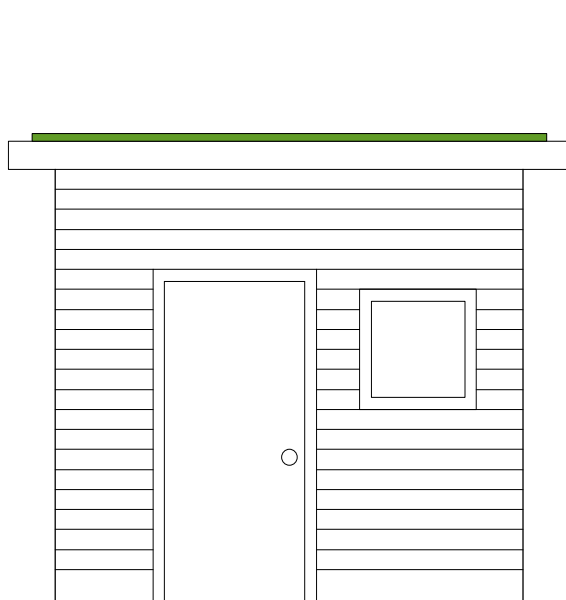

FRONT ELEVATION  
Scale: 1/4" = 1'-0"

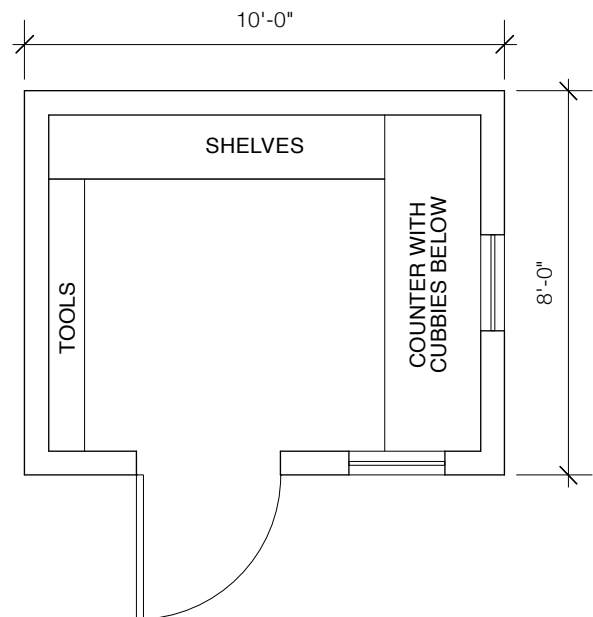

PLAN  
Scale: 1/4" = 1'-0"